

Universal Rack Mount Kit (with Stop Feature)

Installation Instructions for 19" & 23" 2-Post and 4-Post Racks

These Instructions Support the Following Rack Types

- 19" 2-Post and 4-Post racks with EIA Universal and EIA Wide hole spacing (use rack mount kit TMLPMOUNT51)
- 23" 2-Post and 4-Post racks with EIA Universal, EIA Wide and ETSI hole spacing (use rack mount kit TMLPMOUNT52)
- The TMLPMOUNT51 and TMLPMOUNT52 rack mount kits can be installed in 2-Post racks with equipment mounting posts from 3 to 5 inches deep.
- The TMLPMOUNT51 and TMLPMOUNT52 rack mount kits can be installed in 4-Post racks with front equipment mounting rail to rear equipment mounting rail distance not exceeding 24 inches.

Platforms Supported

- 2U (e.g., TSRLT2, TIGPR2U)
- 1U (e.g., TSRMT2)

Content List

- TMLPMOUNT51 (for 19" 2-Post and 4-Post racks)

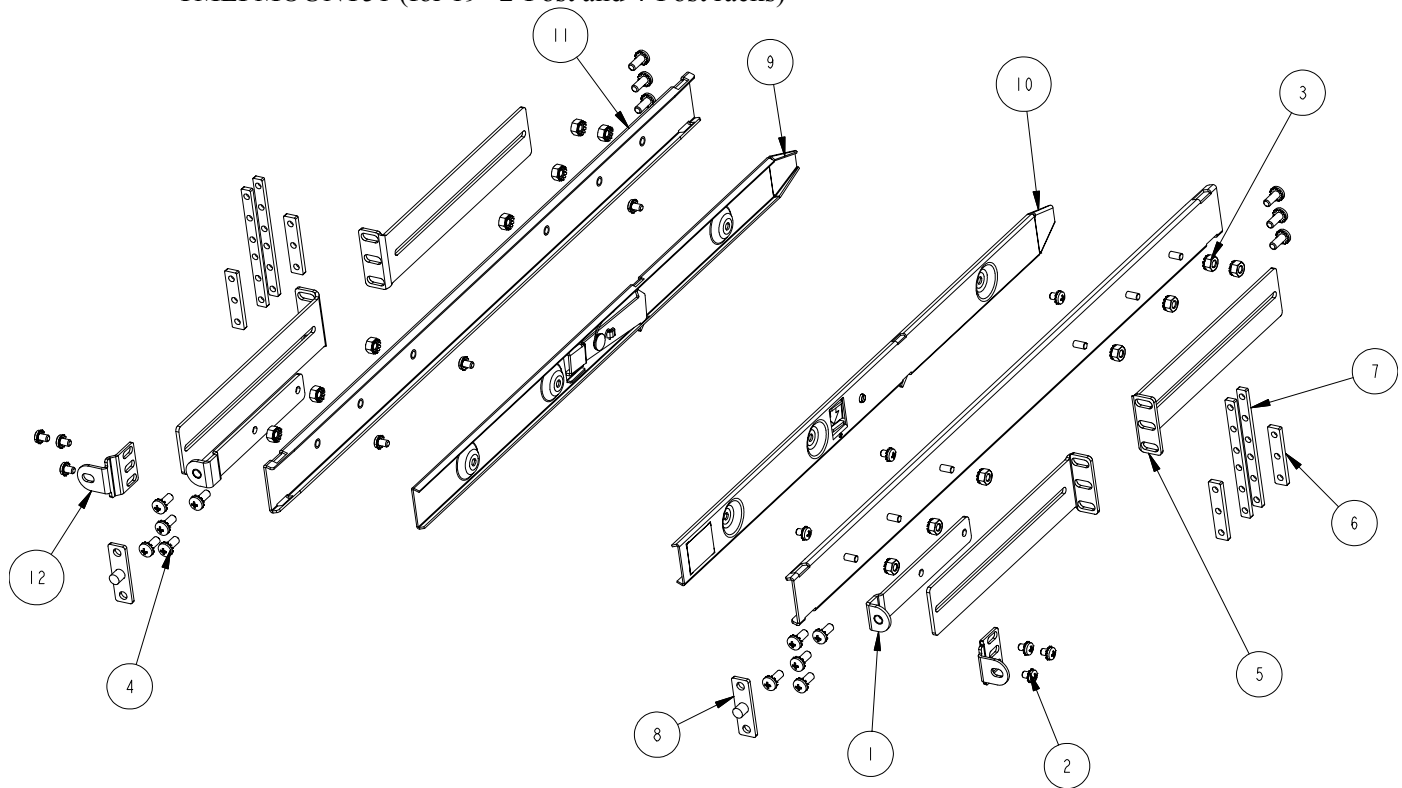

ITEM	QTY	DESCRIPTION
1	2	2-POST MOUNTING BRACKET
2	12	8-32 X 1/4 SEMS SCREW
3	14	8-32, KEPS NUT
4	16	10-32 X 1/2 SEMS SCREW
5	4	19" UNIVERSAL L-BRACKET
6	4	1U EIA BARNUT
7	4	2U EIA BARNUT
8	2	EIA-WIDE ADAPTER
9	1	INNER RAIL ASSEMBLY, LEFT
10	1	INNER RAIL ASSEMBLY, RIGHT
11	2	OUTER RAIL ASSEMBLY, UNIVERSAL
12	2	UNIVERSAL FRONT MOUNTING BRACKET



- TMLPMOUNT52 (for 23" 2-Post and 4-Post racks)

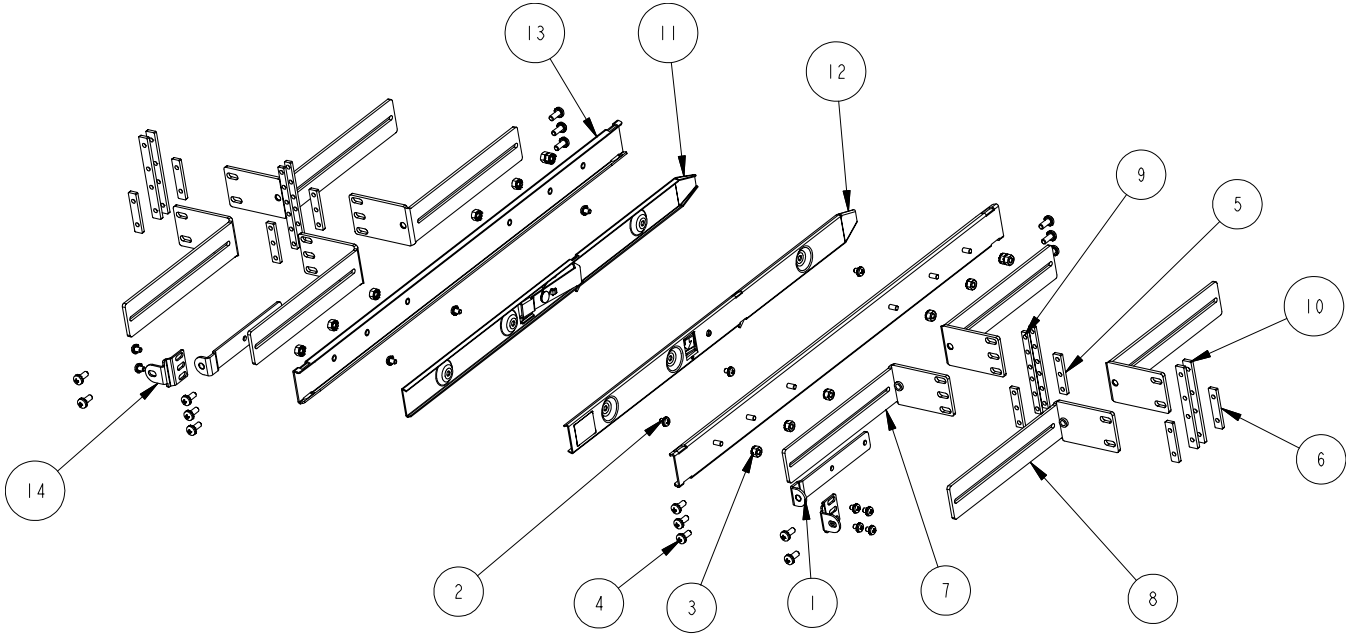

ITEM	QTY	DESCRIPTION
1	2	2-POST MOUNTING BRACKET
2	12	8-32 X 1/4 SEMS SCREW
3	14	8-32, KEPS NUT
4	16	10-32 X 1/2 SEMS SCREW
5	4	1U EIA BARNUT
6	4	1U ETSI BARNUT
7	4	23" EIA UNIVERSAL L-BRACKET
8	4	23" ETSI UNIVERSAL L-BRACKET
9	4	2U EIA BARNUT
10	4	2U ETSI BARNUT
11	1	INNER RAIL ASSEMBLY, LEFT
12	1	INNER RAIL ASSEMBLY, RIGHT
13	2	OUTER RAIL ASSEMBLY, UNIVERSAL
14	2	UNIVERSAL FRONT MOUNTING BRACKET

4-Post Installation Instructions

⇒ NOTE

Although a 2U (e.g., TSRLT2, TIGPR2U) chassis is shown in the illustrations, these instructions also apply to a 1U (e.g., TSRMT2) chassis.

1. Attach the two Inner Rails (marked LEFT and RIGHT) to the chassis, each with three 8-32x1/4" SEMS screws.
2. Attach the Universal Front Mounting Bracket to the chassis, each with two 8-32x1/4" SEMS screws.

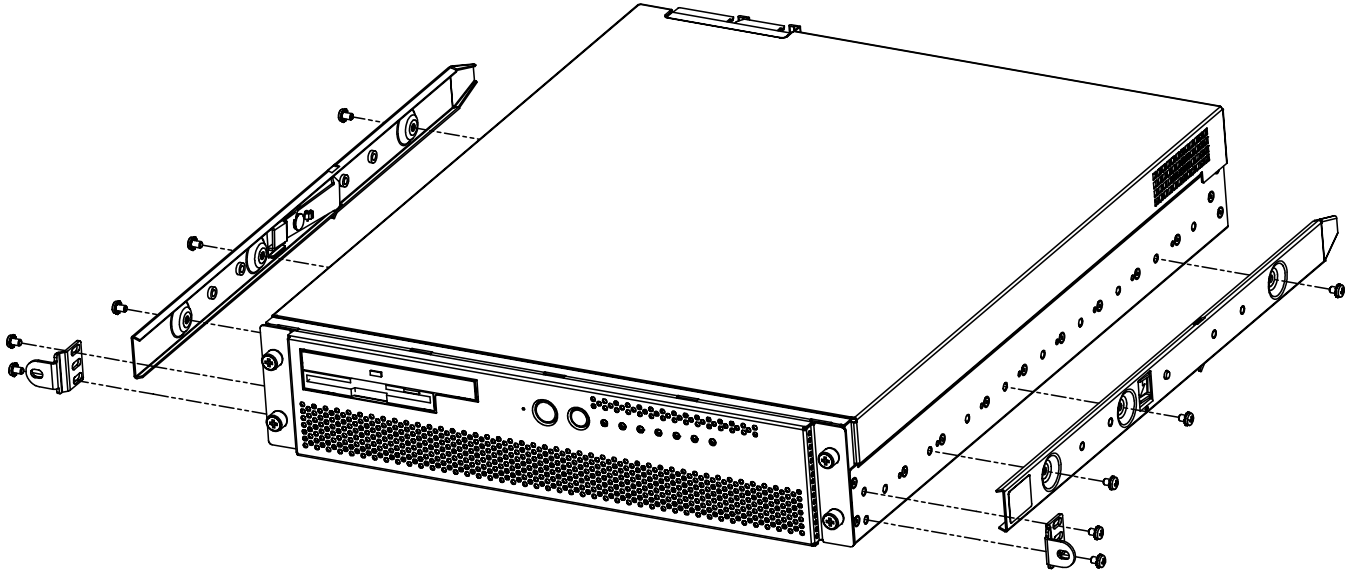

⇒ NOTE

The Universal Front Mounting Bracket can be flipped in order to position the system further forward in the rack (see inset).

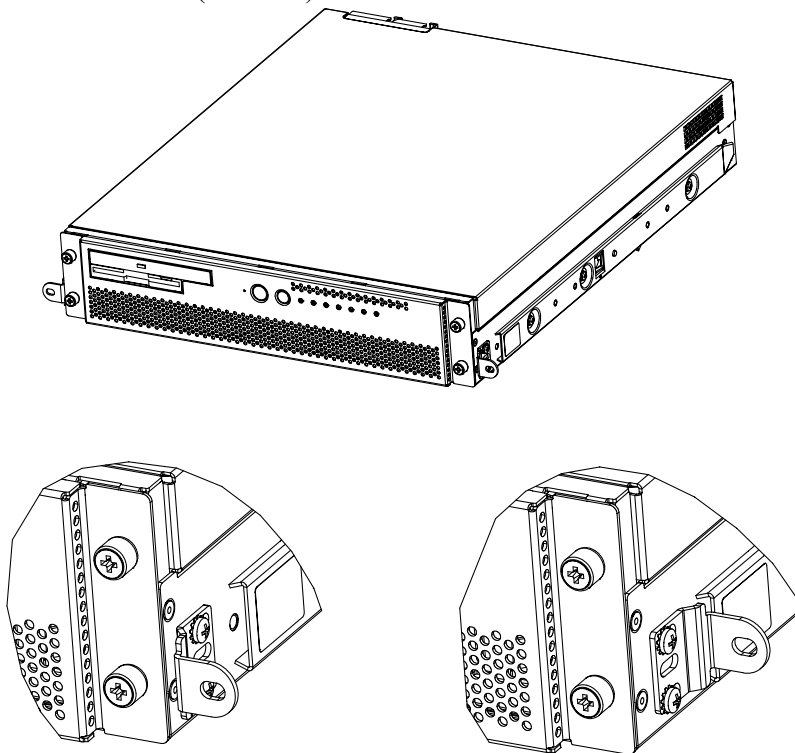

- Using two 8-32 KEPS nuts per L-Bracket, assemble L-Brackets* to the Outer Rail's four outermost threaded studs. (TMLPMOUNT52 contains both EIA and ETSI L-brackets.)

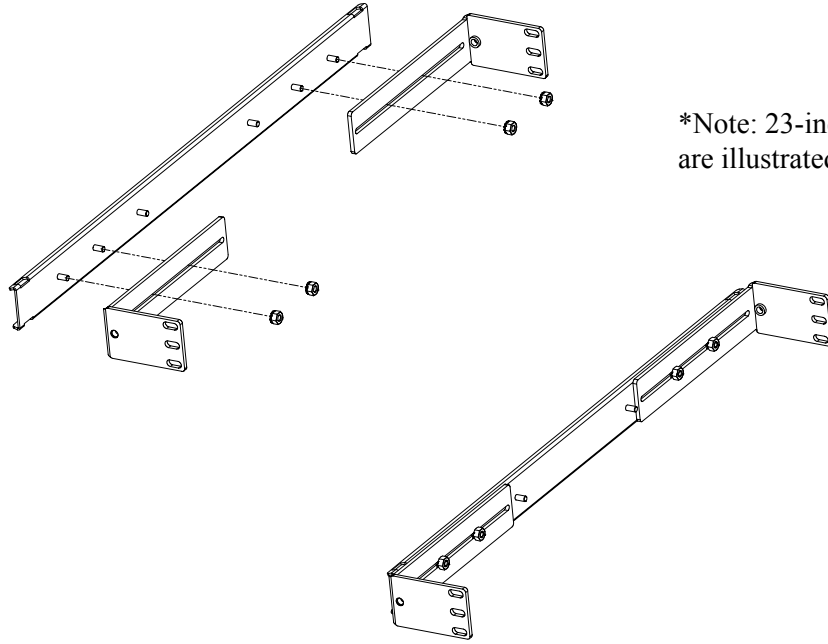

*Note: 23-inch EIA L-brackets are illustrated.

- Install the Outer Rail subassemblies into the rack using ten or twelve (19" or 23" kits, respectively) 10-32x1/2" SEMS screws. If bar-nuts are used, they should be installed such that all threads are aligned vertically, ensuring the center hole is not skewed with respect to the holes on the rack rail.

➤ **NOTE**

If mounting a 1U system in a 1U confined space, four 2U bar-nuts are included to replace the 1U bar-nuts. The 2U bar-nuts need to be installed in the 1U space either above or below the 1U space where this kit is being mounted. When installing multiple 1U systems, the 2U bar-nuts should be used in the next to last kit.

➤ **NOTE**

L-Brackets should be adjusted front-to-back to fit rack depth. The distance between the front equipment mounting rail and rear equipment mounting rail cannot exceed 24 inches.

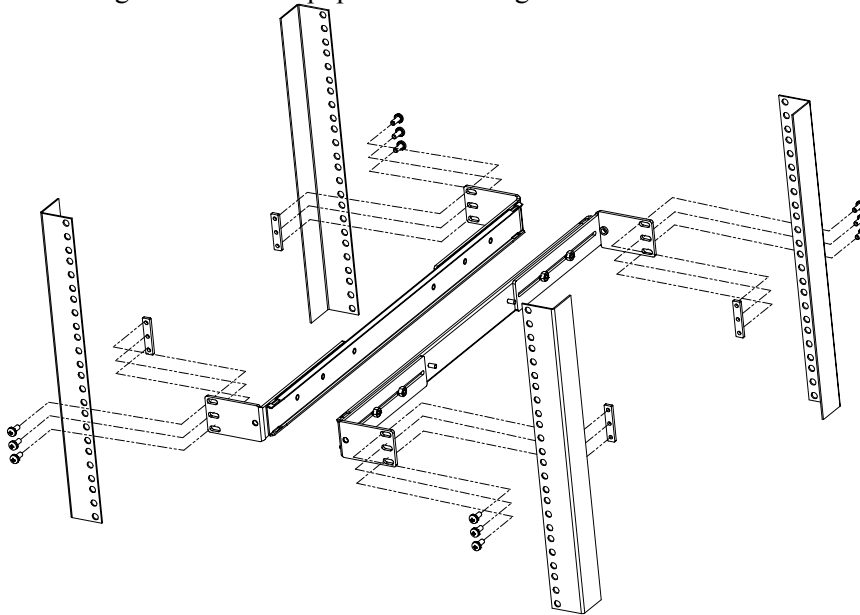

- Slide the system into the rack making sure the Inner Rails are captured by the Outer Rails. Support the weight of the system until the lock features on the Inner Rails engage with the slot features on the Outer Rails. An audible 'click' will be heard.

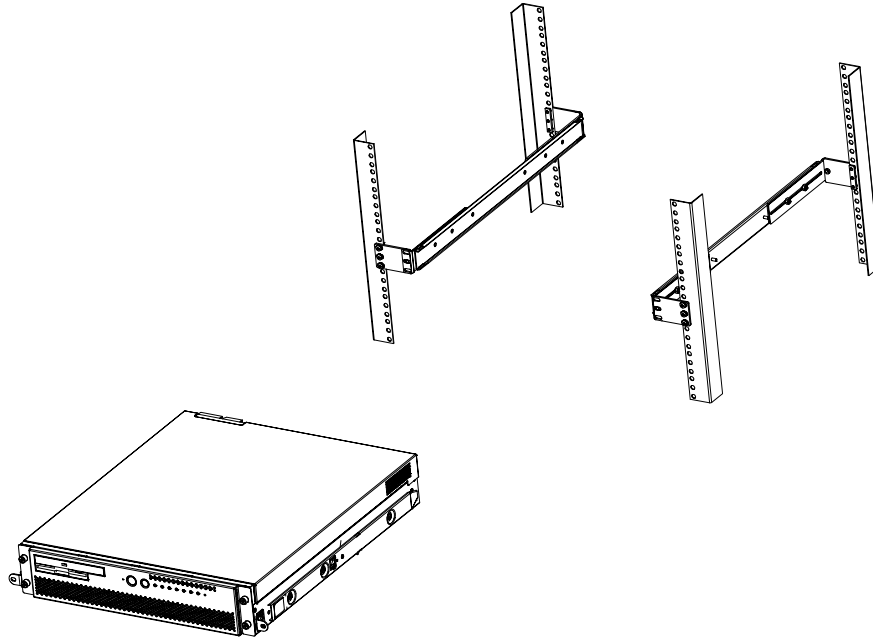

⇒ **NOTE**

Once engaged, the lock features must be released to remove the system from the rack. To release the lock features, depress the two latches with the blue arrows (one on either side) downward. While depressing the lock features and supporting the system weight, pull the system out. Pressure can be released once the lock features disengage from the Outer Rail.

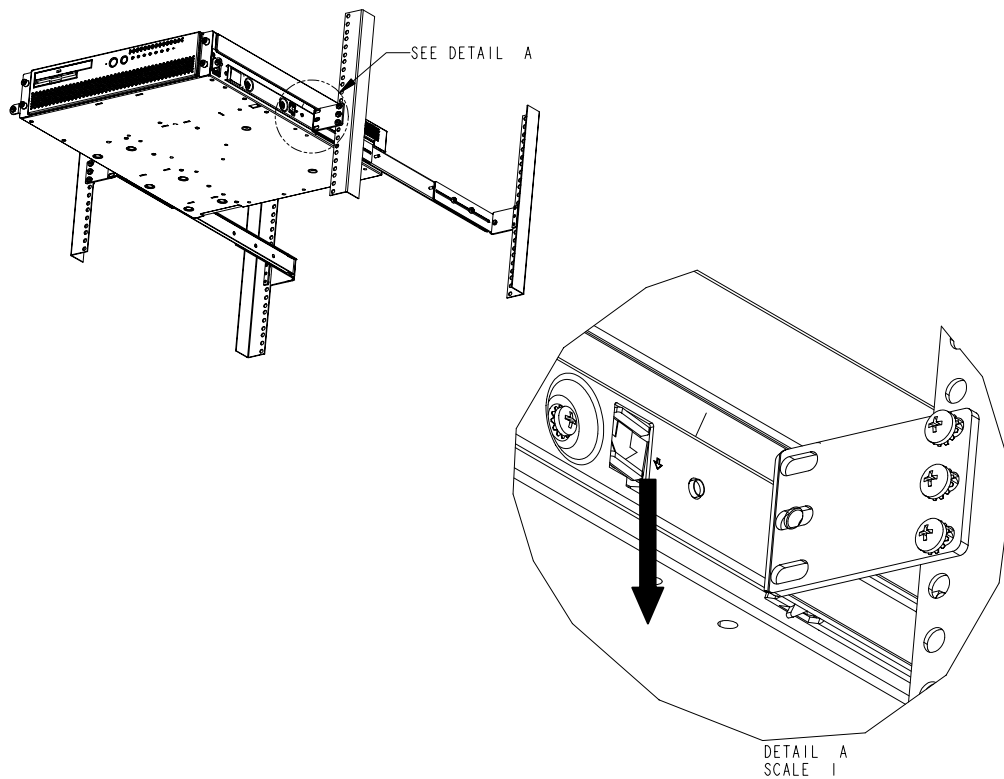

6. Install two 10-32X1/2" SEMS screws to hold the Universal Front Mounting Brackets to either the L-Brackets or the rack's equipment mounting rails (23" or 19", respectively).

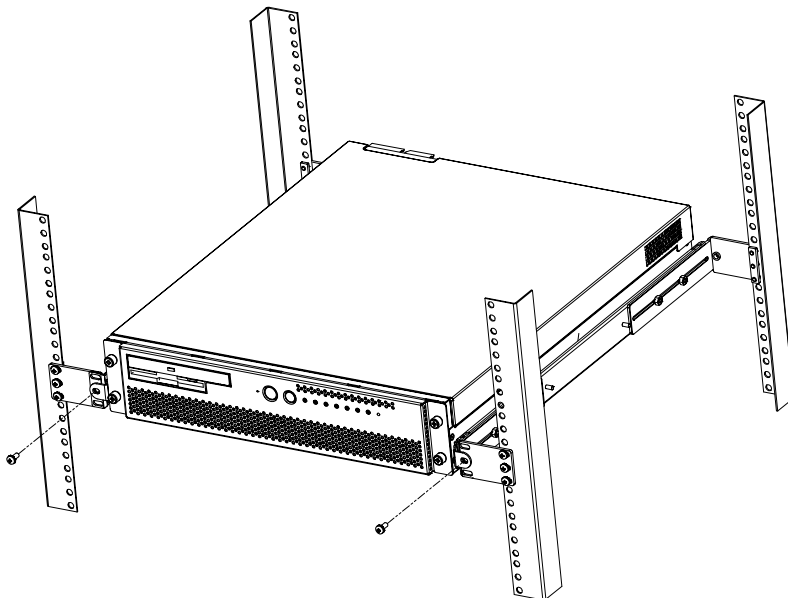

➤ **NOTE**

If installing into a 19-inch 4-post rack that has EIA Wide hole spacing, the EIA Wide Adapter bracket must be used. Install this bracket onto the face of the L-Brackets using the same 10-32x1/2" SEMS screws that fasten the L-Brackets to the rack's front equipment mounting rails.

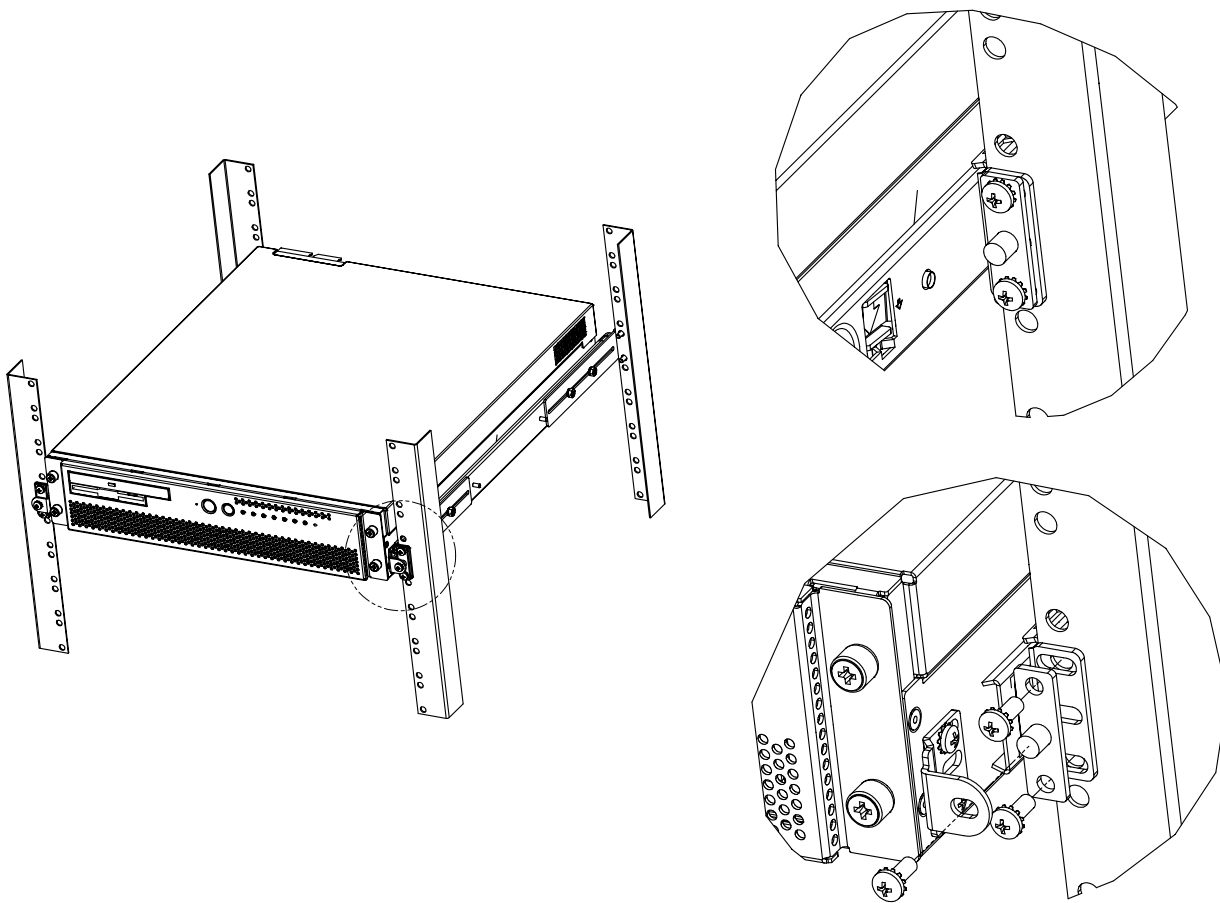

2-Post Installation Instructions

⇒ NOTE

Although a 2U (e.g., TSRLT2, TIGPR2U) chassis is shown in the illustrations, these instructions also apply to a 1U (e.g., TSRMT2) chassis.

1. Attach the two Inner Rails (marked LEFT and RIGHT) to the chassis, each with three 8-32x1/4" SEMS screws.
2. Attach the Universal Front Mounting Bracket to the chassis, each with two 8-32x1/4" SEMS screws.

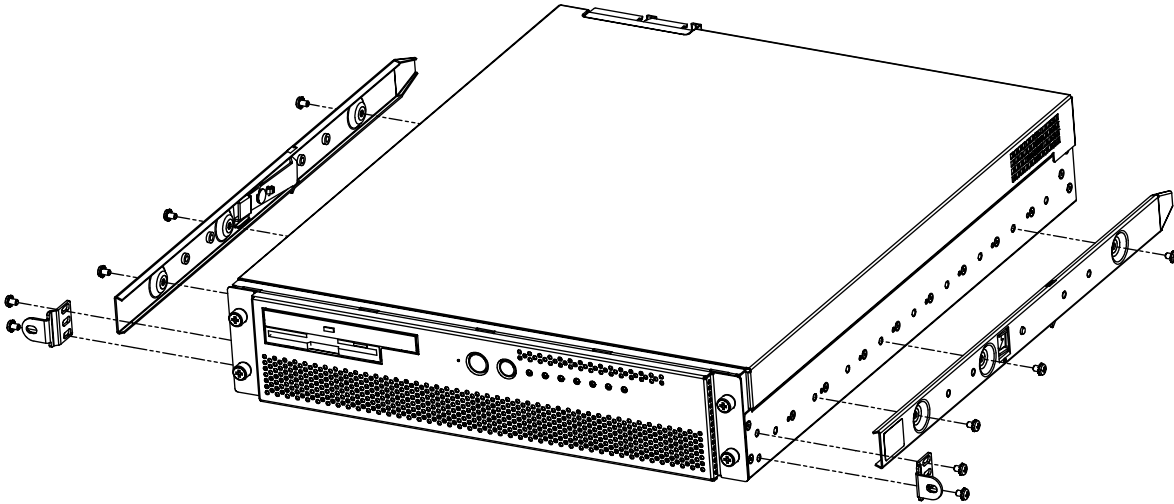

⇒ NOTE

The Universal Front Mounting Bracket can be flipped in order to locate the system further forward in the rack (see inset).

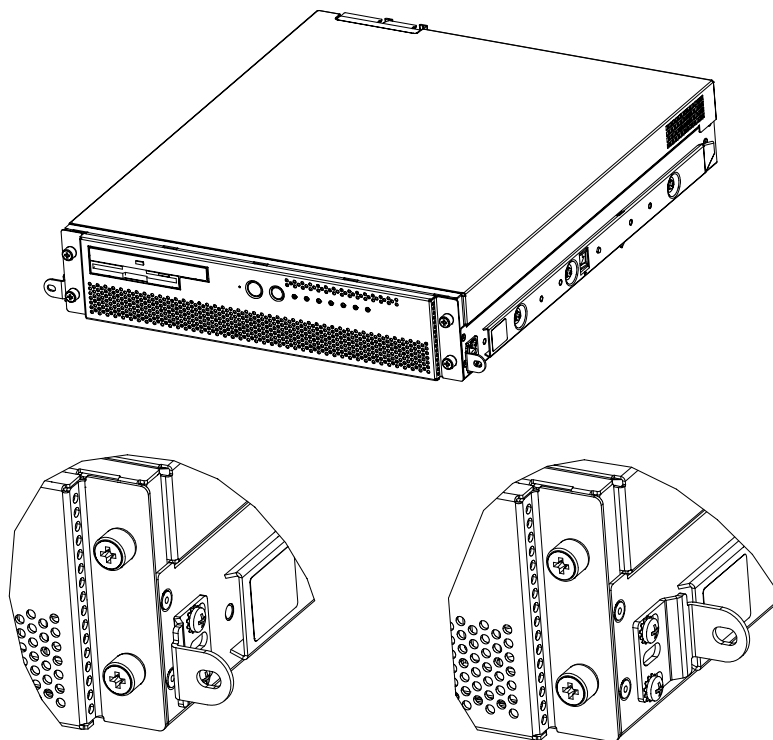

- Using three 8-32 KEPS nuts per L-bracket, assemble the appropriate L-brackets* and the 2-Post Mounting Bracket to the Outer Rail. (TMLPMOUNT52 contains both EIA and ETSI L-brackets.) The 2-Post Mounting bracket is installed onto the two front-most studs, overlapping the front L-bracket and sharing two threaded studs with it.

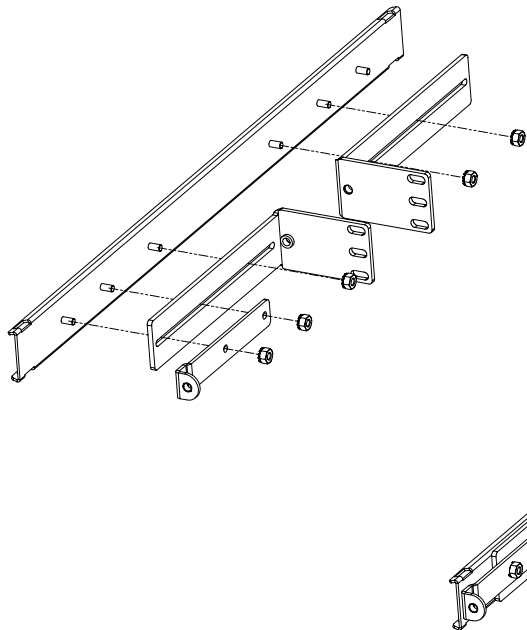

*Note: 23-inch EIA L-brackets are illustrated.

- Install the two Outer Rail subassemblies in the rack using twelve 10-32x1/2" SEMS screws or other appropriate fasteners. If bar-nuts are used, they should be installed such that all threads are aligned vertically, ensuring the center hole is not skewed with respect to the holes on the rack rail.

⇒ **NOTE**

If mounting a 1U system in a 1U confined space, four 2U bar-nuts are included to replace the 1U bar-nuts. The 2U bar-nuts need to be installed in the 1U space either above or below the 1U space where this kit is being mounted. When installing multiple 1U systems, the 2U bar-nuts should be used in the next to last kit.

⇒ **NOTE**

L-Brackets should be adjusted front-to-back to fit rack channel depth.

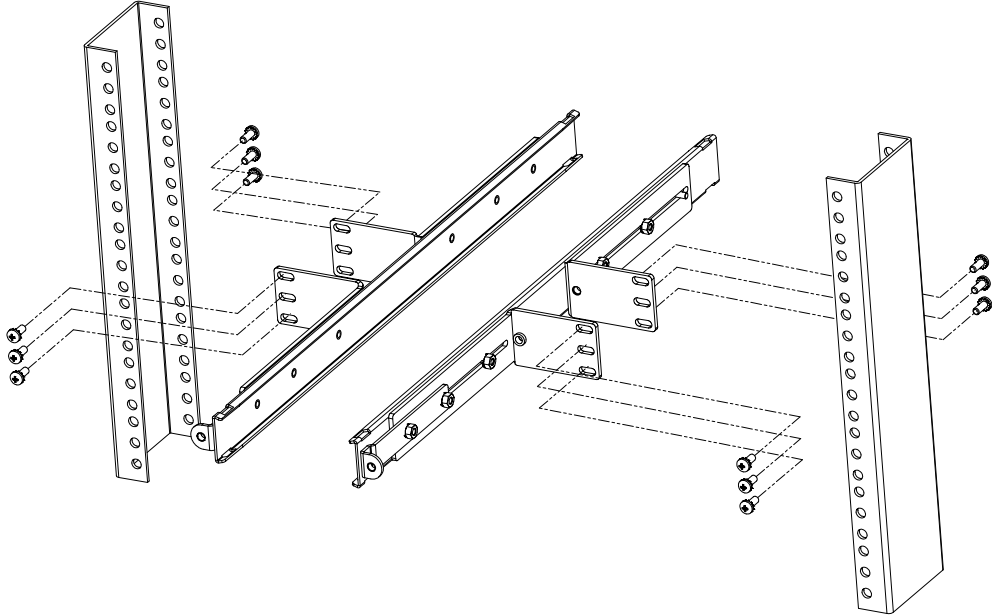

- Slide the system into the rack making sure the Inner Rails are captured by the Outer Rails. Support the weight of the system until lock features on the Inner Rails engage with the slot features on the Outer Rails. An audible 'click' will be heard.

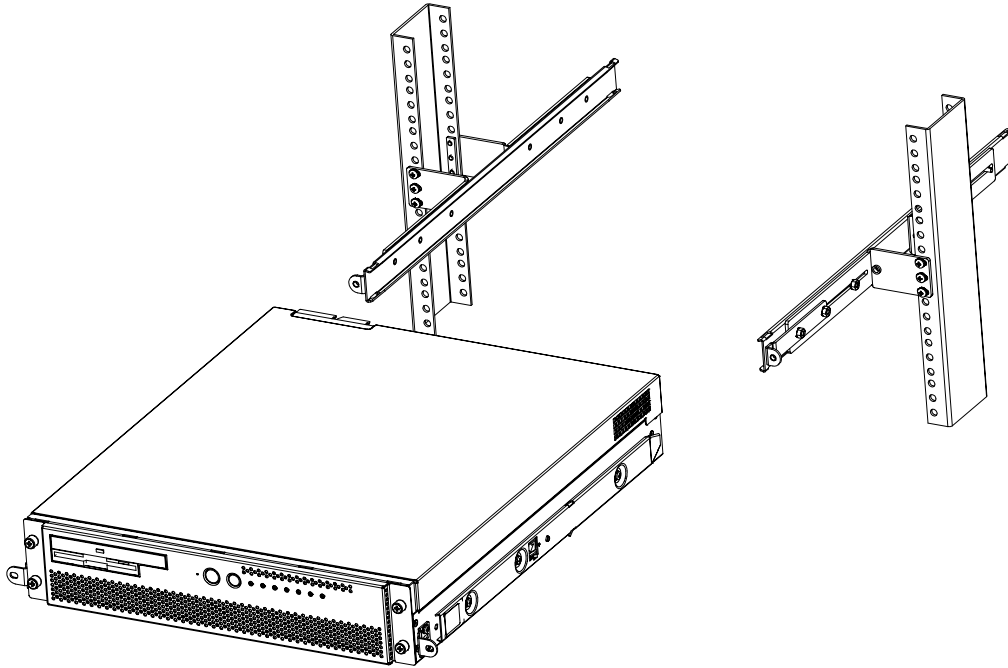

➤ **NOTE**

Once engaged, the lock features must be released to remove the system from the rack. To release the lock features, depress the two latches with the blue arrows (one on either side) downward. While depressing the lock features and supporting the system weight, pull the system out. Pressure can be released once the lock features disengage from the Outer Rail.

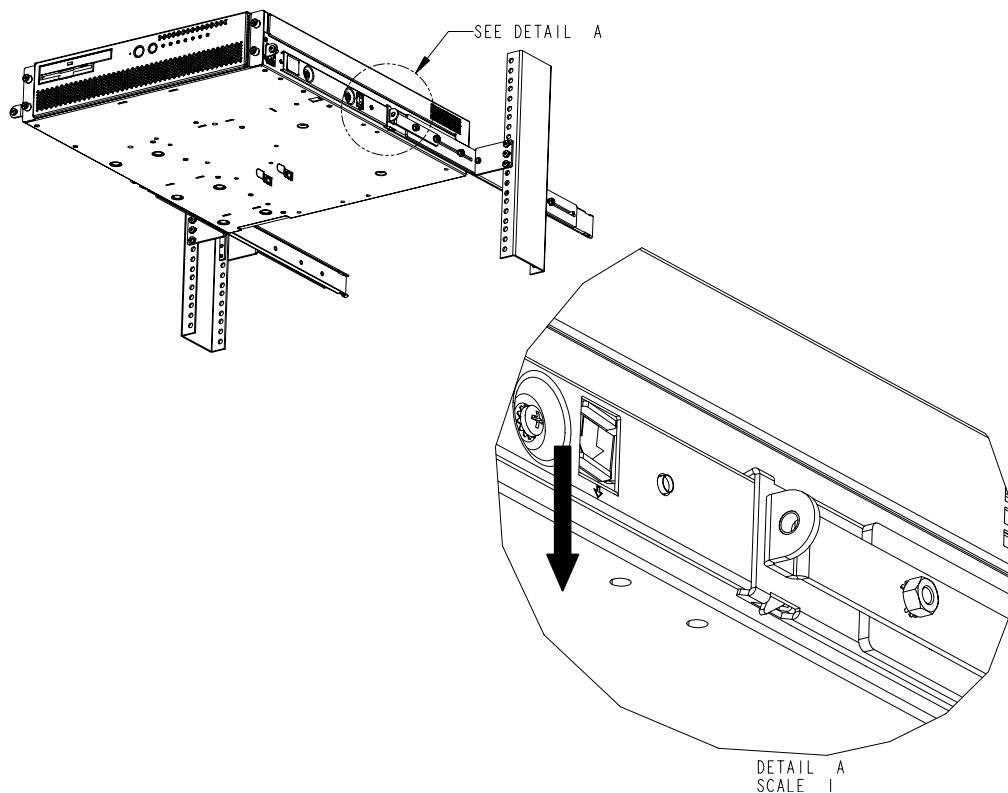

6. Install two 10-32X1/2" SEMS screws to hold the Universal Front Mounting Bracket to the 2-Post Mounting Bracket.

