



Intel® Server Chassis SR2400 Quick Start User's Guide



Thank you for buying an Intel® Server Chassis. The following information will help you assemble your Intel® Server Chassis and install components.

This guide and other supporting documents are located on the web at <http://support.intel.com/support/motherboards/server>

If you are not familiar with ESD (Electrostatic Discharge) procedures used during system integration, please see the Intel® Server Chassis SR2400 User Guide, available on the CD or at <http://support.intel.com/support/motherboards/server>

Minimum Hardware Requirements

To avoid integration difficulties, make sure you have components from each category below:

Required Accessories and Order Codes	
Backplane or Fixed-Drive Kit (You must select one)	
2U SCSI Backplane	A2400SCSIKIT
2U SATA Backplane	A2400SATAKIT
Fixed-Drive Kit	AFIXDRVKIT
Control Panel (You must select one)	
Standard Control Panel	AXRACKFP
Intel® Local Control Panel	AXLCPRACK
Riser Card (You must select one)	
Full-height PCI Express* Riser	ADRPCIEXPR
Full-height PCI-X Riser	ADRPCIXRIS
Full-height PCI-X Active Riser	ADRACTRIS

1 Preparing the Chassis

Observe normal ESD (Electrostatic Discharge) procedures. Place your Intel® Server Chassis on a flat anti-static surface to perform the following integration procedures. Always touch the chassis frame first, before reaching inside to make server board connections or to install components.

2 Remove Top Cover

- 1 Remove the shipping screw.
- 2 Depress the latch.
- 3 Slide cover toward rear and lift upward.

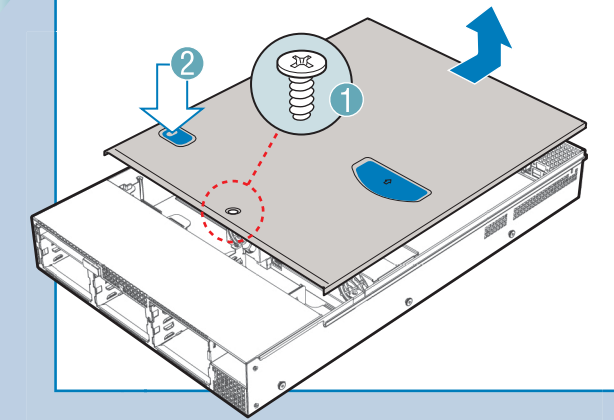

3 Remove Air Duct

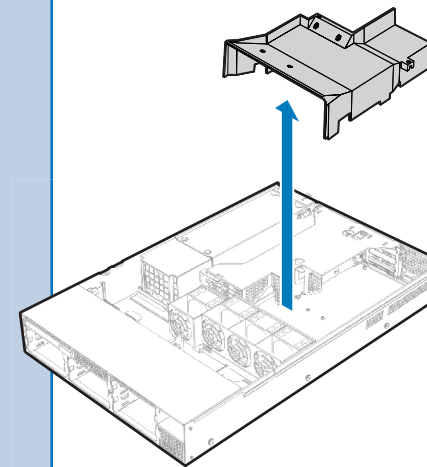

4 Remove Add-in Card Riser Assembly

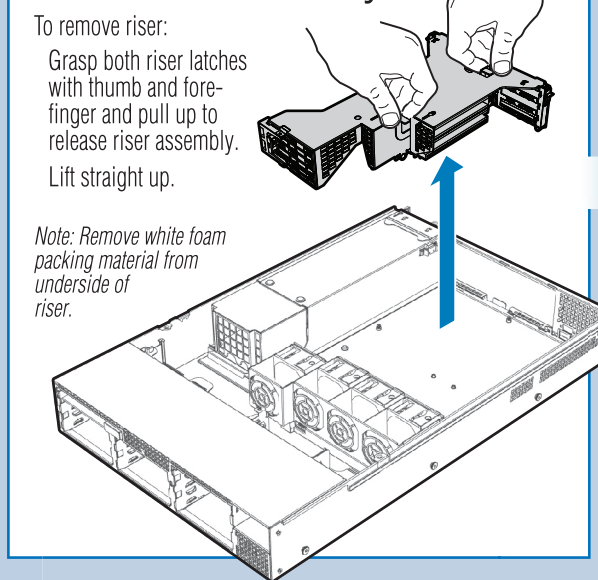

5 Remove Fan Module

Note: Fan module is secured to the chassis by matching slots and standoffs. Make sure module releases fully before lifting out of chassis.

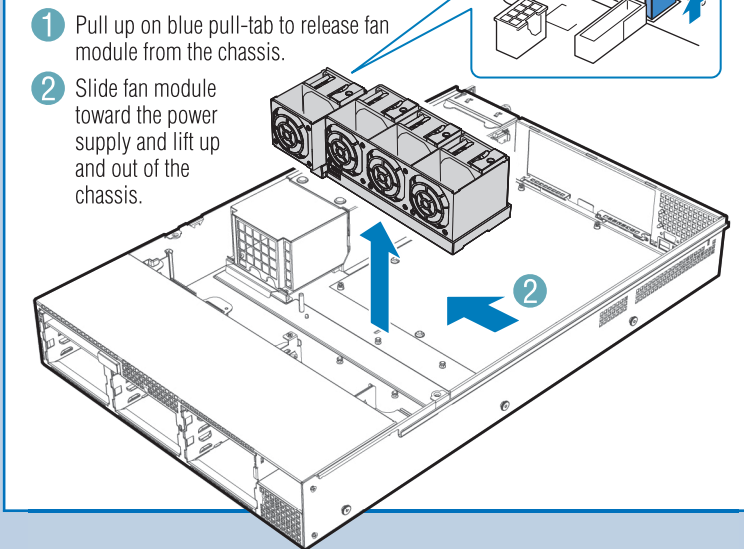

Warning



Read all caution and safety statements in this document before performing any of the instructions. Also see the Intel® Server Board and Server Chassis Safety Information document at: <http://support.intel.com/support/motherboards/server/sb/cs-010770.htm> for complete safety information.

Warning



Installation and service of this product to be performed only by qualified service personnel to avoid risk of injury from electrical shock or energy hazard.

Caution



Observe normal ESD (Electrostatic Discharge) procedures during system integration to avoid possible damage to server board and/or other components.

Tools Required

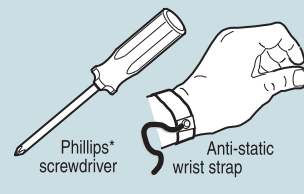

Fastener Identification Guide

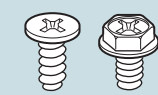

6 Install the Server Board

See your Intel® Server Board Quick Start User's Guide for server board installation instructions. Use the mounting screws that came with your chassis to secure the server board.

Open the Intel® Server Board box. Follow the instructions in the enclosed Intel® Server Board Quick Start User's Guide and return to this document when finished.

Note: Bumpers are pre-installed on the bottom of the server board and standoffs are pre-installed in the chassis.

Note: For a SCSI configuration, attach the SCSI cable to the server board before installing the server board into the chassis. See your SCSI backplane kit for cable and additional installation instructions.

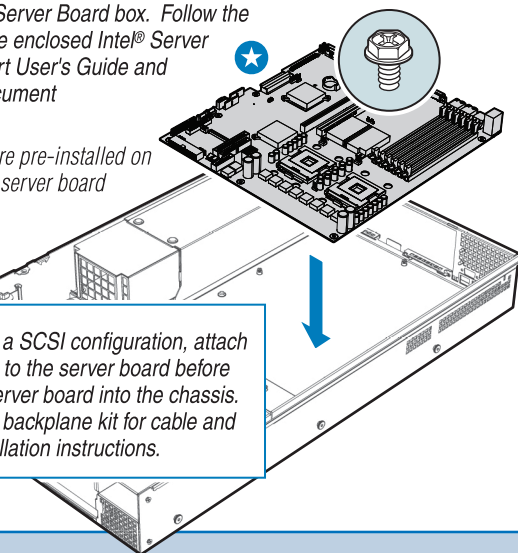

7 Install Front Panel Control Module Select the procedure below that matches your front panel control module

Standard Control Panel

- 1 Attach front panel ribbon cable to control panel connector as shown.
- 2 Attach front panel USB cable to control panel connector as shown.
- 3 Route the server board ends of the front panel ribbon cable and USB cable through the control panel opening before inserting the control panel all the way into the chassis.
- 4 Slide panel into chassis until the release lever clicks into place.

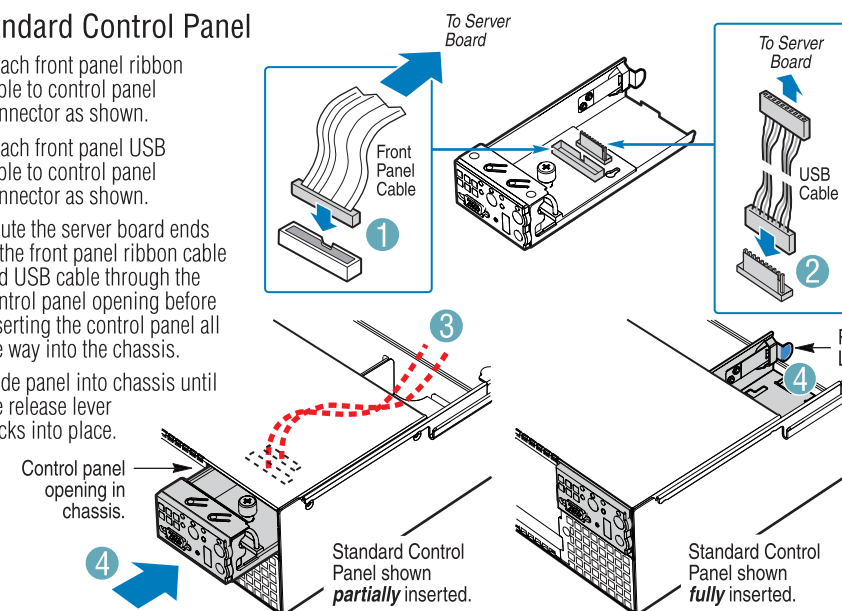

Intel® Local Control Panel (for Intel® Server Board SE7520JR2 only)

- 1 If you plan to install the bezel that matches the Intel® Local Control Panel, remove the thumbscrew and slide the back half of the tray rearward as shown and re-install the thumbscrew into the metal tabs.
- 2 When using a bezel with the Local Control Panel, you need to change out the LCP plastic front panel.
- 3 If you are not using the optional bezel, make sure the back half of the tray is secured in the "shortened" position.
- 4 Attach front panel ribbon cable to control panel connector as shown.
- 5 Attach front panel USB cable to control panel connector as shown.
- 6 Route the server board ends of the front panel ribbon cable and USB cable through the control panel opening before inserting the control panel all the way into the chassis.
- 7 Slide panel into chassis until the release lever clicks into place.

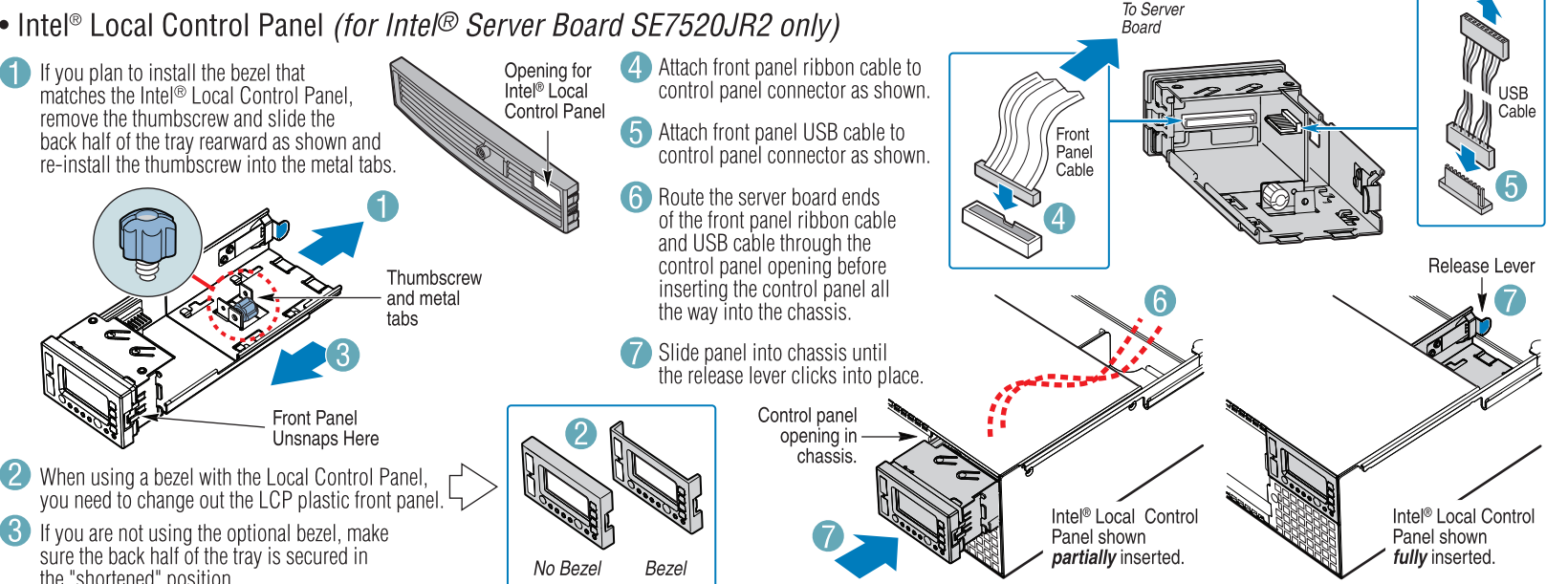

8 Install Control Panel Cables (for fixed-drive systems only)

- 1 Route front panel USB cable as shown. Note location of chassis pin. USB cable routes between power supply and pin.
- 2 Connect USB cable to server board as shown.
- 3 Route front panel ribbon cable as shown and make connection to server board. For hot-swap drives, see the manual included with the backplane accessory kit for front panel cable routing.

Note that cable will be IN FRONT of fan module when module is installed later.

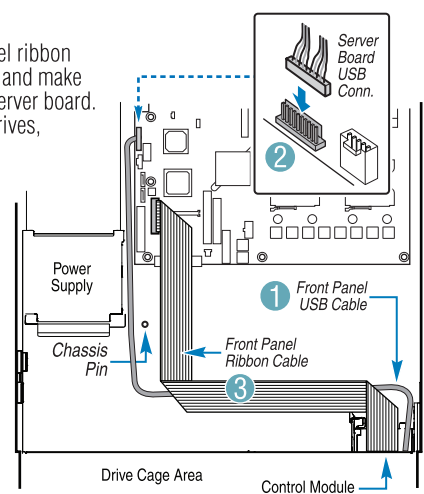

9 Make Power Connections

Main, CPU, and Power Supply Signal Cables

- 1 Connect main power cable to server board as shown.
- 2 Connect CPU power cable.
- 3 Connect power supply signal cable to server board as shown.

Note location of chassis pin. Power cables route between power supply and pin.

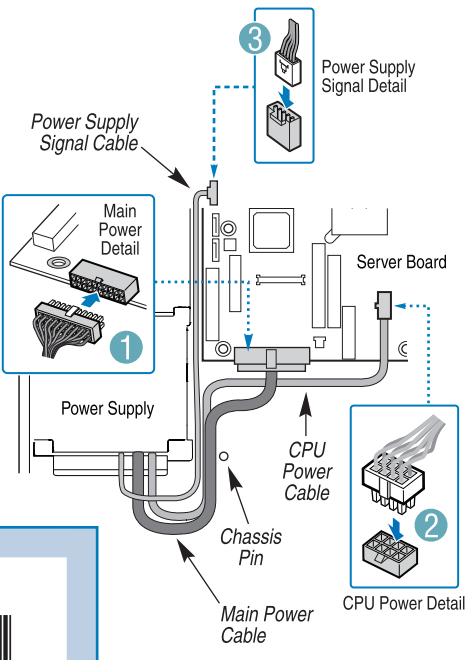

C51502-003



10 Install Additional Fans to Fan Module (optional)

Your chassis fan module may differ from the diagram. For a typical installation, four fans are pre-installed. These four fans, closest to the server board, must be in place for proper system cooling. Optional fans are added at the front of the fan module.

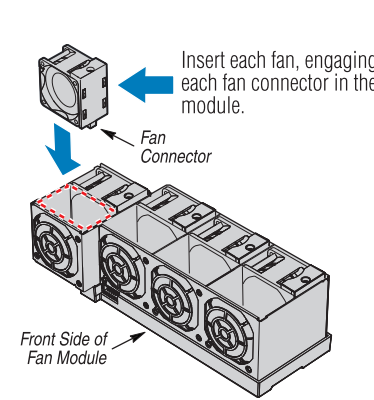

11 Install Backplane or Fixed Drive Kit

Follow the instructions included with your backplane kit or with your fixed-drive kit.

The diagram below shows an example of one of the backplane options.

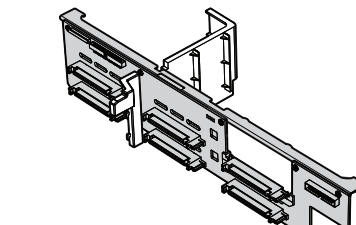

12 Install Intel® Management Module (optional)

