

Non-Hot Swap Fan Module Kit Install Guide: Intel® Storage Server SSR212MC2BR/SSR212MC2RBR

**A Guide for Technically Qualified Assemblers of Intel® Identified Subassemblies/
Products**

Intel Order Number: E12736-002



Disclaimer

Information in this document is provided in connection with Intel® products. No license, express or implied, by estoppel or otherwise, to any intellectual property rights is granted by this document. Except as provided in Intel's Terms and Conditions of Sale for such products, Intel assumes no liability whatsoever, and Intel disclaims any express or implied warranty, relating to sale and/or use of Intel® products including liability or warranties relating to fitness for a particular purpose, merchantability, or infringement of any patent, copyright or other intellectual property right. Intel products are not designed, intended or authorized for use in any medical, life saving, or life sustaining applications or for any other application in which the failure of the Intel product could create a situation where personal injury or death may occur. Intel may make changes to specifications and product descriptions at any time, without notice.

Intel® server boards contain a number of high-density VLSI and power delivery components that need adequate airflow for cooling. Intel's own chassis are designed and tested to meet the intended thermal requirements of these components when the fully integrated system is used together. It is the responsibility of the system integrator that chooses not to use Intel developed server building blocks to consult vendor datasheets and operating parameters to determine the amount of airflow required for their specific application and environmental conditions. Intel Corporation can not be held responsible if components fail or the server board does not operate correctly when used outside any of their published operating or non-operating limits.

Intel, Intel Pentium, and Intel Xeon are trademarks or registered trademarks of Intel Corporation or its subsidiaries in the United States and other countries.

* Other names and brands may be claimed as the property of others.

Copyright © 2007-2008, Intel Corporation. All Rights Reserved

Safety Information

Important Safety Instructions

Read all caution and safety statements in this document before performing any of the instructions. See also Intel Server Boards and Server Chassis Safety Information on the *Intel® Server Deployment Toolkit CD* and/or at:

<http://support.intel.com/support/motherboards/server/sb/cs-010770.htm>.

Wichtige Sicherheitshinweise

Lesen Sie zunächst sämtliche Warnung und Sicherheitshinweise in diesem Dokument, bevor Sie eine der Anweisungen ausführen. Beachten Sie hierzu auch die Sicherheitshinweise zu Intel-Serverplatinen und Servergehäusen auf der *Intel® Server Deployment Toolkit CD* oder unter:

<http://support.intel.com/support/motherboards/server/sb/cs-010770.htm>.

Consignes de sécurité

Lisez attention toutes les consignes de sécurité et les mises en garde indiquées dans ce document avant de suivre toute instruction. Consultez Intel Server Boards and Server Chassis Safety Information sur le *Intel® Server Deployment Toolkit CD* ou bien rendez-vous sur le site:

<http://support.intel.com/support/motherboards/server/sb/cs-010770.htm>.

Instrucciones de seguridad importantes

Lea todas las declaraciones de seguridad y precaución de este documento antes de realizar cualquiera de las instrucciones. Vea Intel Server Boards and Server Chassis Safety Information en el *Intel® Server Deployment Toolkit CD* y/o en:

<http://support.intel.com/support/motherboards/server/sb/cs-010770.htm>.

重要安全指导

在执行任何指令之前，请阅读本文件中的所有注意事项及安全声明。并参阅 <http://support.intel.com/support/motherboards/server/sb/CS-010770.htm> 上的 *Intel Server Boards and Server Chassis Safety Information*（《Intel 服务器主板与服务器机箱安全信息》）。

Warnings

Heed safety instructions: Before working with your server product, whether you are using this guide or any other resource as a reference, pay close attention to the safety instructions. You must adhere to the assembly instructions in this guide to ensure and maintain compliance with existing product certifications and approvals. Use only the described, regulated components specified in this guide. Use of other products / components will void the UL listing and other regulatory approvals of the product and will most likely result in noncompliance with product regulations in the region(s) in which the product is sold.

System power on/off: The power button DOES NOT turn off the system AC power. To remove power from system, you must unplug the AC power cord from the wall outlet. Make sure the AC power cord is unplugged before you open the chassis, add, or remove any components.

Hazardous conditions, devices and cables: Hazardous electrical conditions may be present on power, telephone, and communication cables. Turn off the server and disconnect the power cord, telecommunications systems, networks, and modems attached to the server before opening it. Otherwise, personal injury or equipment damage can result.

Electrostatic discharge (ESD) and ESD protection: ESD can damage disk drives, boards, and other parts. We recommend that you perform all procedures in this chapter only at an ESD workstation. If one is not available, provide some ESD protection by wearing an antistatic wrist strap attached to chassis ground any unpainted metal surface on your server when handling parts.

ESD and handling boards: Always handle boards carefully. They can be extremely sensitive to ESD. Hold boards only by their edges. After removing a board from its protective wrapper or from the server, place the board component side up on a grounded, static free surface. Use a conductive foam pad if available but not the board wrapper. Do not slide board over any surface.

Installing or removing jumpers: A jumper is a small plastic encased conductor that slips over two jumper pins. Some jumpers have a small tab on top that you can grip with your fingertips or with a pair of fine needle nosed pliers. If your jumpers do not have such a tab, take care when using needle nosed pliers to remove or install a jumper; grip the narrow sides of the jumper with the pliers, never the wide sides. Gripping the wide sides can damage the contacts inside the jumper, causing intermittent problems with the function controlled by that jumper. Take care to grip with, but not squeeze, the pliers or other tool you use to remove a jumper, or you may bend or break the pins on the board.

Contents

Safety Information	iii
Important Safety Instructions	iii
Wichtige Sicherheitshinweise	iii
Consignes de sécurité	iii
Instrucciones de seguridad importantes	iii
Warnings.....	iv
Non-Hot Swap Fan Module Kit Install Guide	1
Tools Needed	1
Kit Contents	1
Fan Module Kit Installation Instructions	1
Prepare System	2
Remove Faulty Fan	3
Install Replacement Cooling Fan	4
Complete Setup	5

Non-Hot Swap Fan Module Kit Install Guide

Ten high-speed single-rotor axial fans are housed in a cooling cage, located centrally within the enclosure, between the drive bays and the server board. This minimizes noise and ensures maximum airflow through the power supply units.

Airflow is front to rear with cooling air being drawn across the drives, through the fans, and pressurizing the rear of the enclosure. The pressurized rear allows the power supply units to draw the air that it requires; perforations at the rear of the chassis allow cooling air to flow over the processor heatsinks, server board and PCI card(s).

This fan module is NOT a hot swap fan and can only be installed in the following products:

Product Code	MM#
SSR212MC2BR	893628
SSR212MC2RBR	893519

Tools Needed

- Flat-head screwdriver

Kit Contents

Fan Module Kit Installation Instructions

Fan Module Kit (FMCFANS)

Item	Quantity
Fan module	5
Install Guide	1

Warning: *The enclosure cover should only be removed by qualified service personnel as it provides access to a service area. Potential hazards include:*

- *Energy hazard*
- *Rotating fans*
- *Hot surfaces*
- *Access to power supply unit openings*

Warning: Upon completion of fan replacement, the enclosure cover MUST be properly closed and latched by turning the lock mechanism with a flat-head screwdriver to the “locked” position.

Prepare System

Caution: Before performing any maintenance on the storage server, back up the data.

1. Read all caution and safety statements listed in this document before performing any of the steps. See the *Intel® Server Boards and Server Chassis Safety Information* document at <http://support.intel.com/support/motherboards/server/sb/cs-010770.htm> for a complete listing of all caution and safety statements. Before performing any maintenance on the system, back up the data.
2. Turn off all peripheral devices connected to the storage server. Power down the storage server.
3. Disconnect the AC power cord(s).
4. Release the enclosure cover by turning the lock mechanism with a flat-head screwdriver to the “unlocked” position (see letter “A” in the following figure) and sliding the cover back until it stops (see letter “B”).

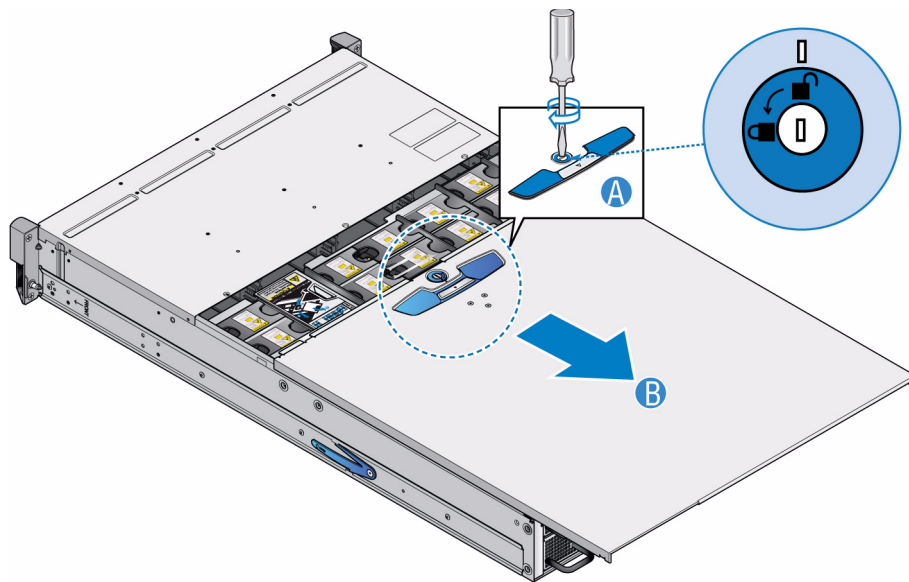

AF0002100

Figure 1. Releasing the Enclosure Cover

Remove Faulty Fan

5. Grip the faulty fan with finger and thumb and pull it upwards to unplug it from the enclosure management PCB. Remove fan from the enclosure.

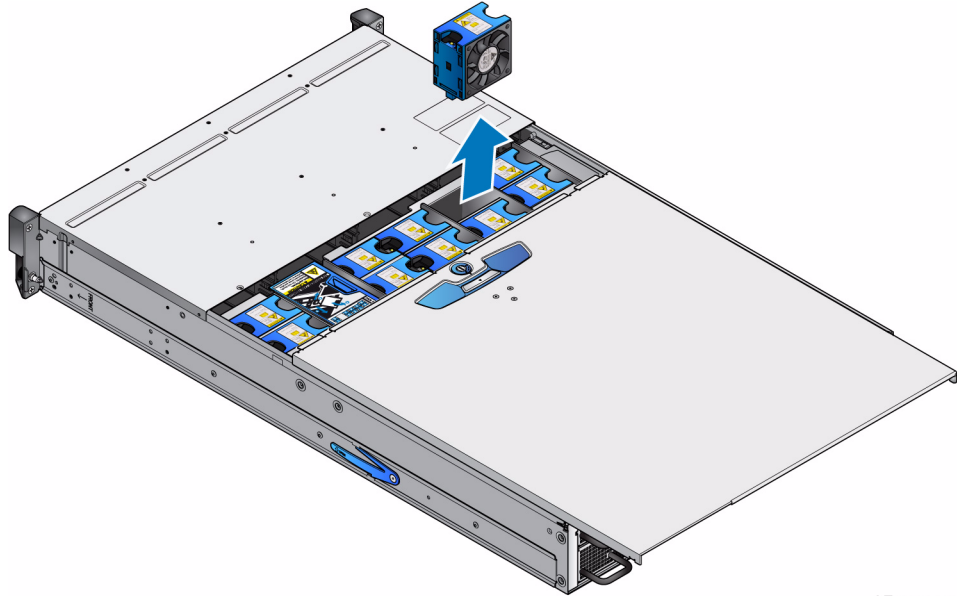

AF0001652

Figure 2. Removing a Fan Module

Install Replacement Cooling Fan

6. Check the new fan for damage. Do not install it if there are any visible signs of damage.
7. Grip the fan and push it all the way into the empty slot until it fits firmly and is level with the other fans. When properly installed, the fan will plug into the enclosure management PCB.

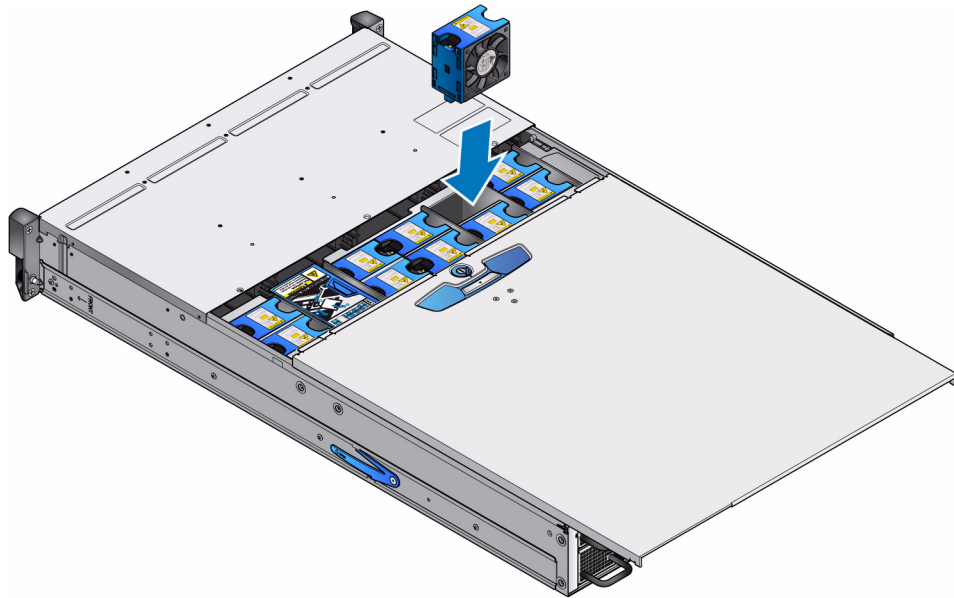

AF0001653

Figure 3. Installing a Fan Module

Complete Setup

8. Reconnect all peripheral devices and the AC power cord(s). Power up the storage server. Ensure that the fan LED turns off.
9. Close the enclosure cover (see letter “A” in the following figure) and latch securely by turning the lock mechanism with a flat-head screwdriver until the “locked” symbol aligns with the notch in cover (see letter “B”).

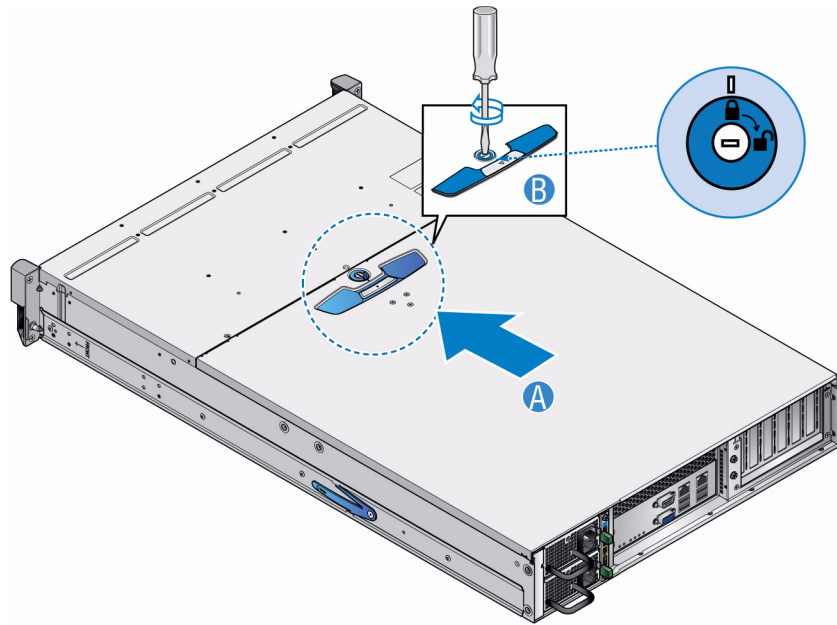

AF0002098

Figure 4. Re-installing Enclosure Cover

